

Madison, Wisconsin

INDEX OF SHEETS

SHEET NO.	TITLE
1	
U1-U3	SANITARY PLAN AND PROFILE

# CITY OF MADISON

## CITY ENGINEERING DIVISION

### DEPARTMENT OF PUBLIC WORKS

# PLAN OF PROPOSED IMPROVEMENT

## RIMROCK INTERCEPTOR – INDUSTRIAL DRIVE EXTENSION

CITY PROJECT NO. 11446

CONTRACT NO. ~~8374~~ 8374

PUBLIC IMPROVEMENT PROJECT APPROVED

SEPTEMBER 6, 2016

BY THE COMMON COUNCIL OF MADISON, WISCONSIN

PUBLIC IMPROVEMENT DESIGN APPROVED BY:





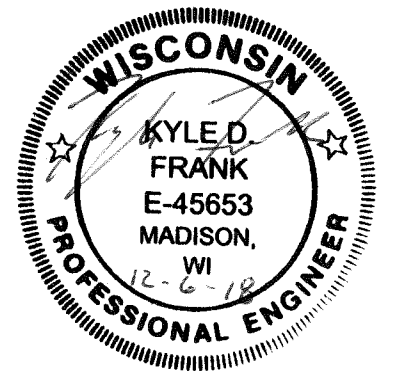

 12/7/18  
 City Engineer Date

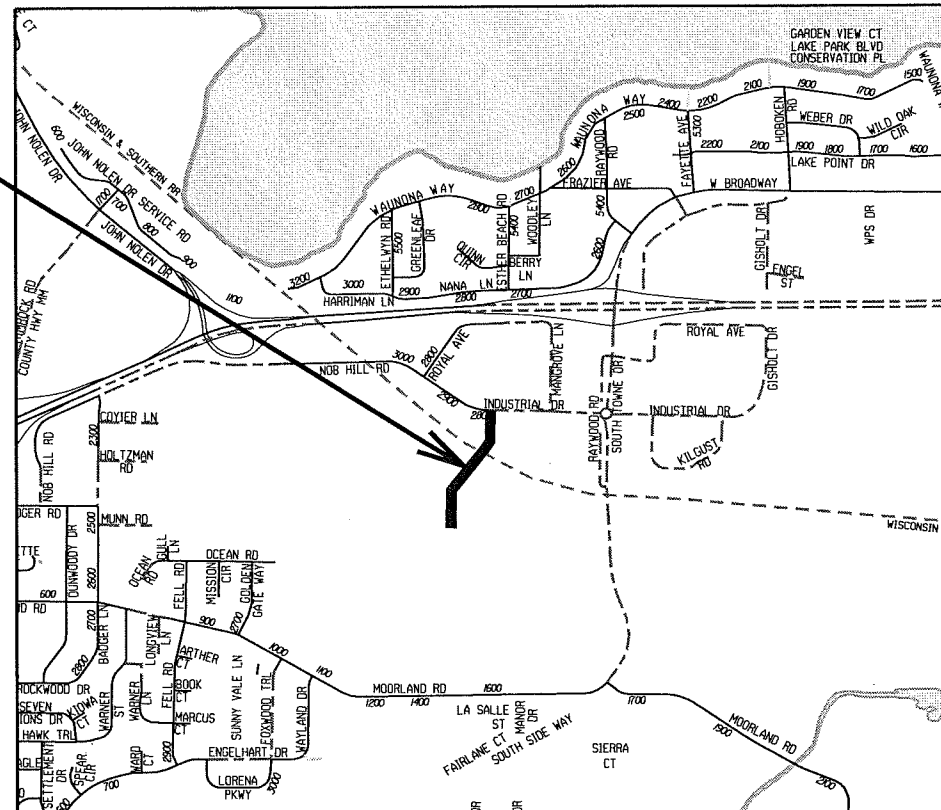
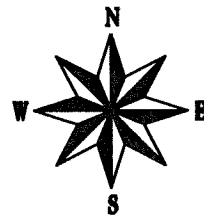
SANITARY SEWER DESIGNED BY:



PROJECT LOCATION



CONVENTIONAL SIGNS	
FIELD VERIFY ALL UTILITY LOCATIONS	
GAS	 G
STORM SEWER	 ST
SANITARY SEWER	 SAN
WATER	 W
OVERHEAD ELECTRIC	 OH
POWER POLE	 □

NOTES:

ALL GUTTERS SHALL DRAIN WITH A MINIMUM GRADE OF 0.50% TOWARD STORM SEWER INLETS.

SIDEWALK RAMPS AND CURB THRU SIDEWALK RAMPS SHALL HAVE A MAXIMUM SLOPE OF 1" PER 12". SIDEWALK AND CURB RAMPS SHALL BE CONSTRUCTED WITH A SIDE SLOPE OF 2.00%. SIDEWALK SHALL HAVE A MINIMUM LONGITUDINAL SLOPE OF 0.50% AND A MAXIMUM LONGITUDINAL SLOPE OF 5.00%.

PLOT SCALE:

PLOT NAME:

REV. DATE:

ORIGINATOR: CITY OF MADISON, STREETS DIVISION

NOTE: TREE REMOVALS SHOULD BE MINIMIZED AND SHOULD ONLY BE AS NEEDED FOR ACCESS AND CONSTRUCTION. CITY ENGINEERING PROVIDE APPROVAL FOR TREE REMOVALS BEFORE TREES ARE REMOVED

CONTRACTOR SHALL USE SWAMP MATS AS NEEDED TO ACCESS WORK AREAS. SWAMP MATS SHALL BE PAID UNDER MOBILIZATION AND SHALL BE REMOVED AT THE END OF THE PROJECT.

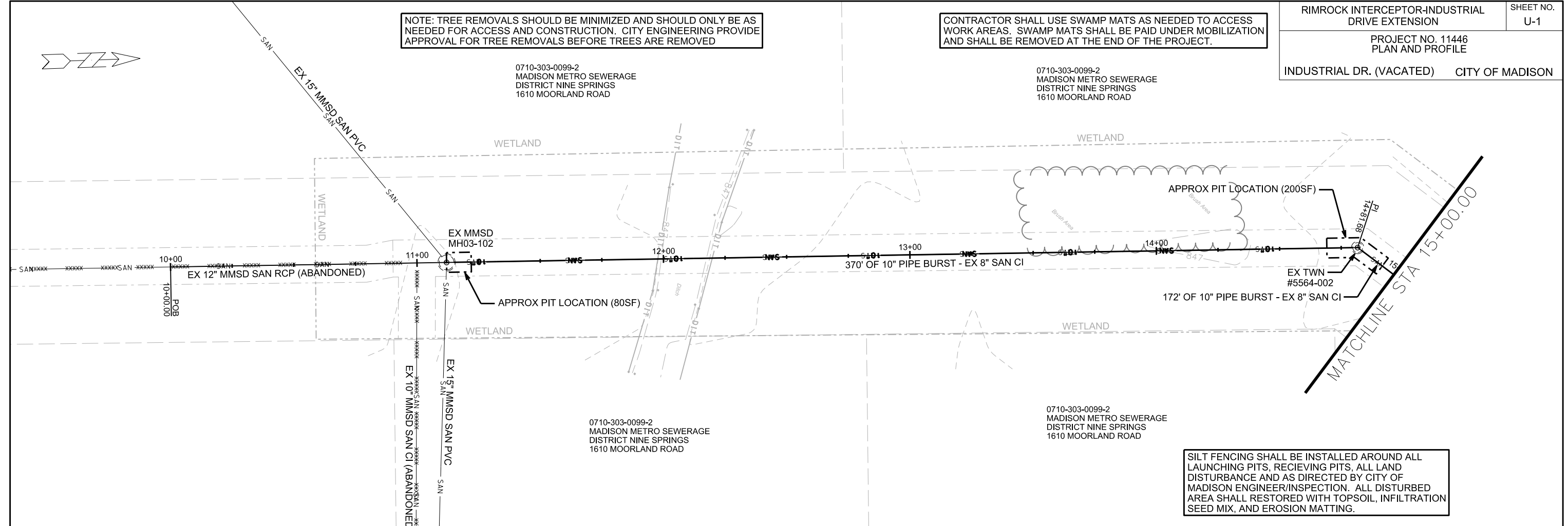

SILT FENCING SHALL BE INSTALLED AROUND ALL LAUNCHING PITS, RECEIVING PITS, ALL LAND DISTURBANCE AND AS DIRECTED BY CITY OF MADISON ENGINEER/INSPECTION. ALL DISTURBED AREA SHALL RESTORED WITH TOPSOIL, INFILTRATION SEED MIX, AND EROSION MATTING.

\* NOTE: CONTRACTOR SHALL CONTACT RAY SCHNEIDER (608) 347-3628 OR RAYS@MADSEWER.ORG, FIVE DAYE PRIOR TO MAKING THE CONNECTION TO MMSD MH3-103 TO ARRANGE FOR INSPECTION OF THE CONNECTION. CONTRACTOR SHALL BE RESPONSIBLE FOR THE PERMIT APPLICATION FEE (\$1,125.00)

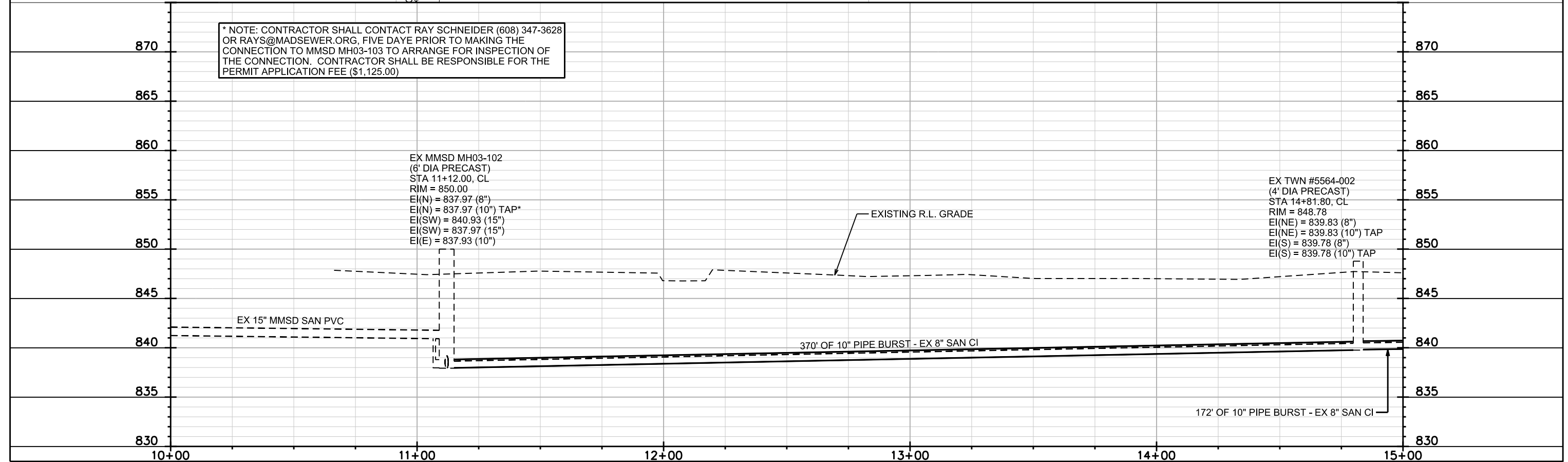

PLOT SCALE:  
 PLOT NAME:  
 REV. DATE:  
 ORIGINATOR: CITY OF MADISON, STREETS DIVISION

CONTRACTOR SHALL USE SWAMP MATS AS NEEDED TO ACCESS WORK AREAS. SWAMP MATS SHALL BE PAID UNDER MOBILIZATION AND SHALL BE REMOVED AT THE END OF THE PROJECT.

0710-303-0099-2  
 MADISON METRO SEWERAGE DISTRICT NINE SPRINGS  
 1610 MOORLAND ROAD

0710-303-0099-2  
 MADISON METRO SEWERAGE DISTRICT NINE SPRINGS  
 1610 MOORLAND ROAD

NOTE: TREE REMOVALS SHOULD BE MINIMIZED AND SHOULD ONLY BE AS NEEDED FOR ACCESS AND CONSTRUCTION. CITY ENGINEERING PROVIDE APPROVAL FOR TREE REMOVALS BEFORE TREES ARE REMOVED

SILT FENCING SHALL BE INSTALLED AROUND ALL LAUNCHING PITS, RECEIVING PITS, ALL LAND DISTURBANCE AND AS DIRECTED BY CITY OF MADISON ENGINEER/INSPECTION. ALL DISTURBED AREA SHALL RESTORED WITH TOPSOIL, INFILTRATION SEED MIX, AND EROSION MATTING.

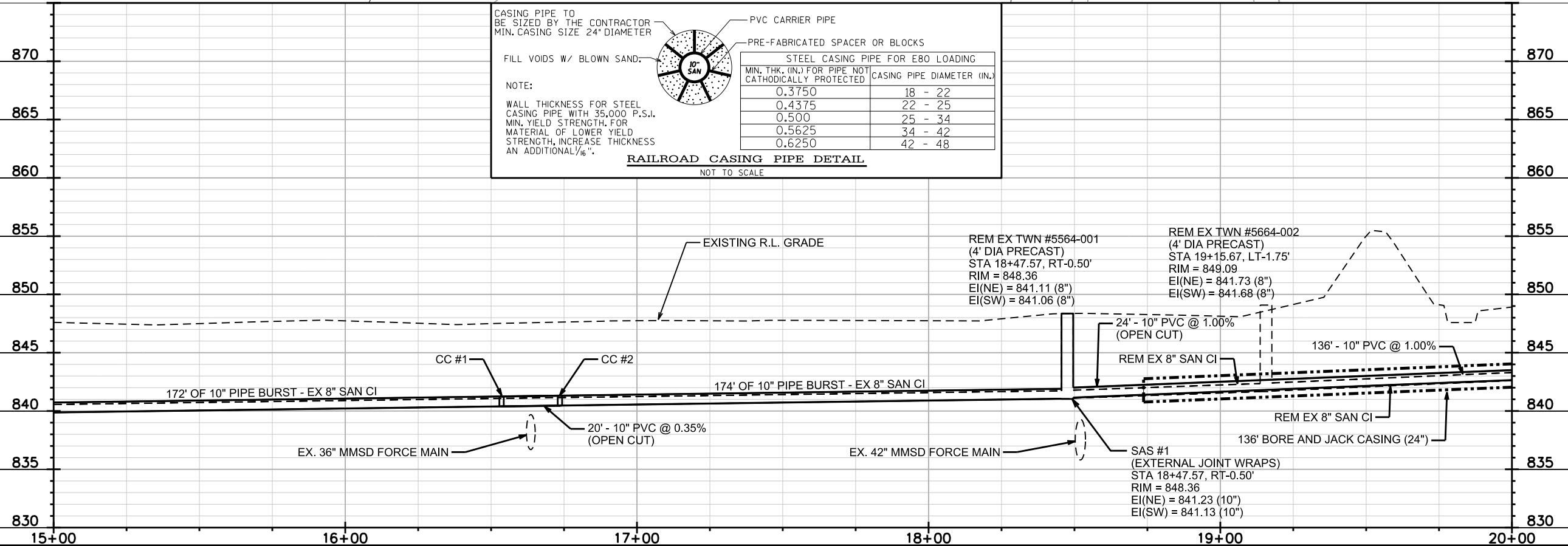
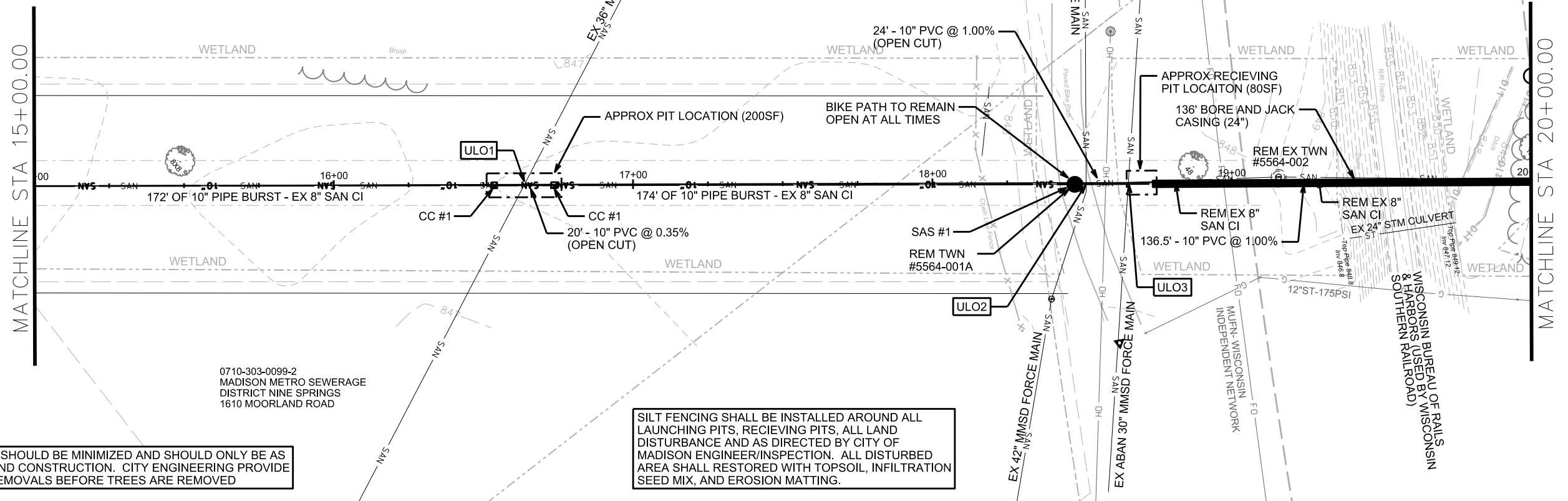

CASING PIPE TO BE SIZED BY THE CONTRACTOR MIN. CASING SIZE 24" DIAMETER

FILL VOIDS W/ BLOWN SAND.

NOTE:  
 WALL THICKNESS FOR STEEL CASING PIPE WITH 35,000 P.S.I. MIN. YIELD STRENGTH. FOR MATERIAL OF LOWER YIELD STRENGTH, INCREASE THICKNESS AN ADDITIONAL 1/16".

STEEL CASING PIPE FOR E80 LOADING	
MIN. THK. (IN.) FOR PIPE NOT CATHODICALLY PROTECTED	CASING PIPE DIAMETER (IN.)
0.3750	18 - 22
0.4375	22 - 25
0.500	25 - 34
0.5625	34 - 42
0.6250	42 - 48

**RAILROAD CASING PIPE DETAIL**  
 NOT TO SCALE

PLOT SCALE:  
 PLOT NAME:  
 REV. DATE:  
 ORIGINATOR: CITY OF MADISON, STREETS DIVISION

CONTRACTOR SHALL USE SWAMP MATS AS NEEDED TO ACCESS WORK AREAS. SWAMP MATS SHALL BE PAID UNDER MOBILIZATION AND SHALL BE REMOVED AT THE END OF THE PROJECT.

SILT FENCING SHALL BE INSTALLED AROUND ALL LAUNCHING PITS, RECEIVING PITS, ALL LAND DISTURBANCE AND AS DIRECTED BY CITY OF MADISON ENGINEER/INSPECTION. ALL DISTURBED AREA SHALL RESTORED WITH TOPSOIL, INFILTRATION SEED MIX, AND EROSION MATTING.

0710-302-1502-6  
UEC PROPERTIES LLC  
2855 INDUSTRIAL DRIVE

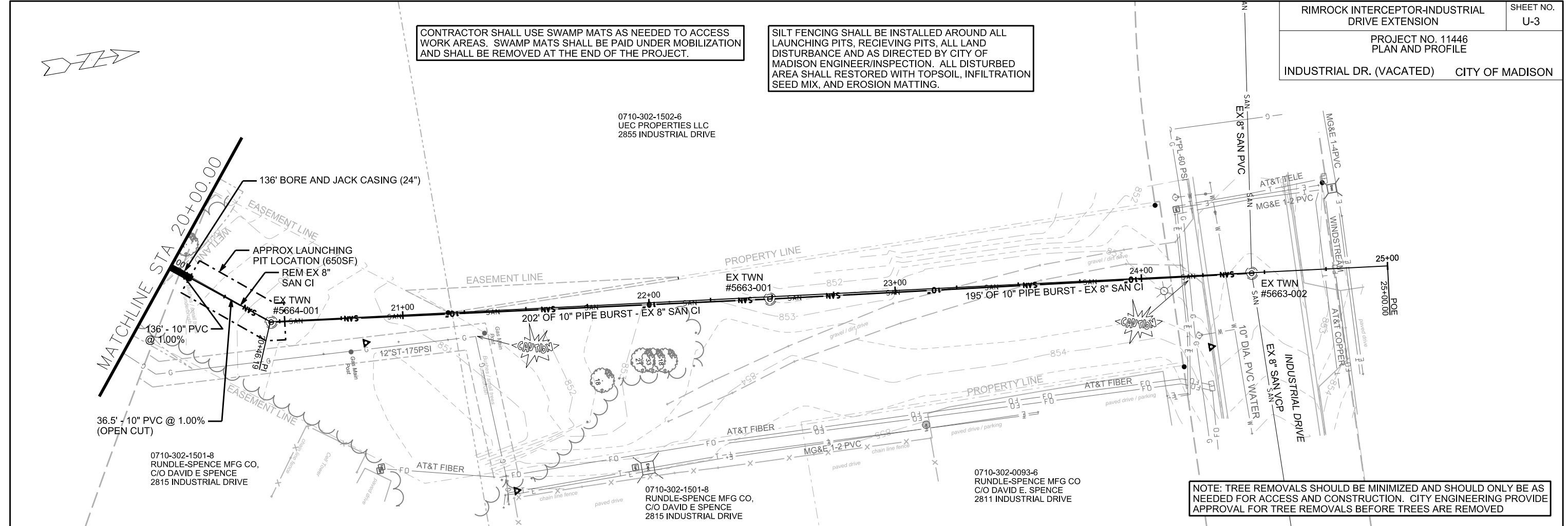

NOTE: TREE REMOVALS SHOULD BE MINIMIZED AND SHOULD ONLY BE AS NEEDED FOR ACCESS AND CONSTRUCTION. CITY ENGINEERING PROVIDE APPROVAL FOR TREE REMOVALS BEFORE TREES ARE REMOVED

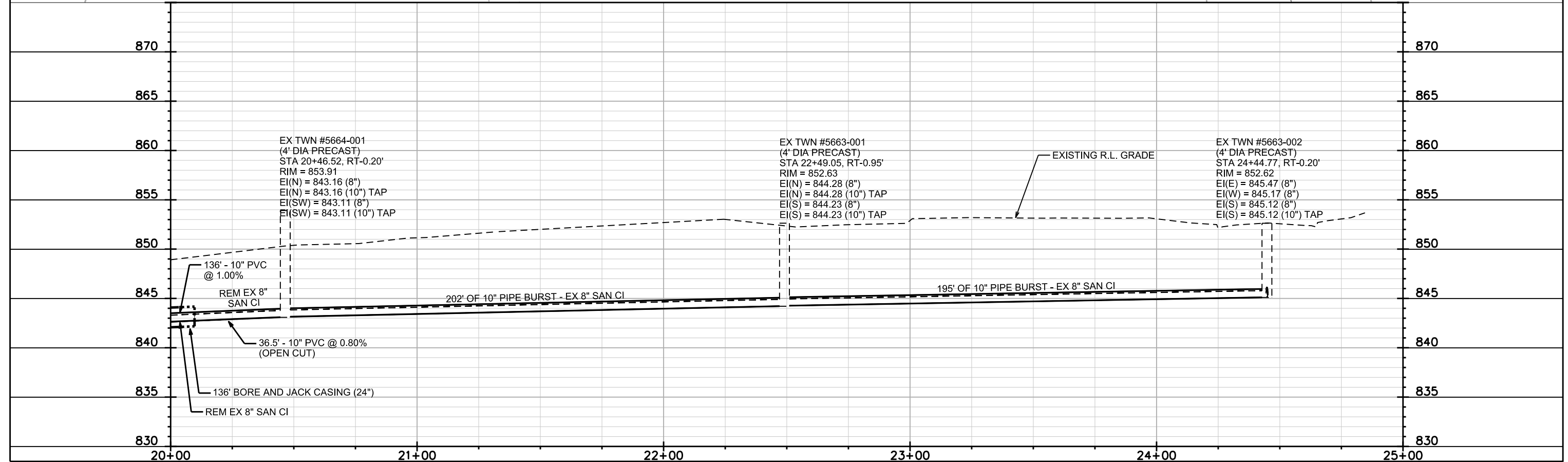

PLOT SCALE:

PLOT NAME:

REV. DATE:

ORIGINATOR: CITY OF MADISON, STREETS DIVISION